

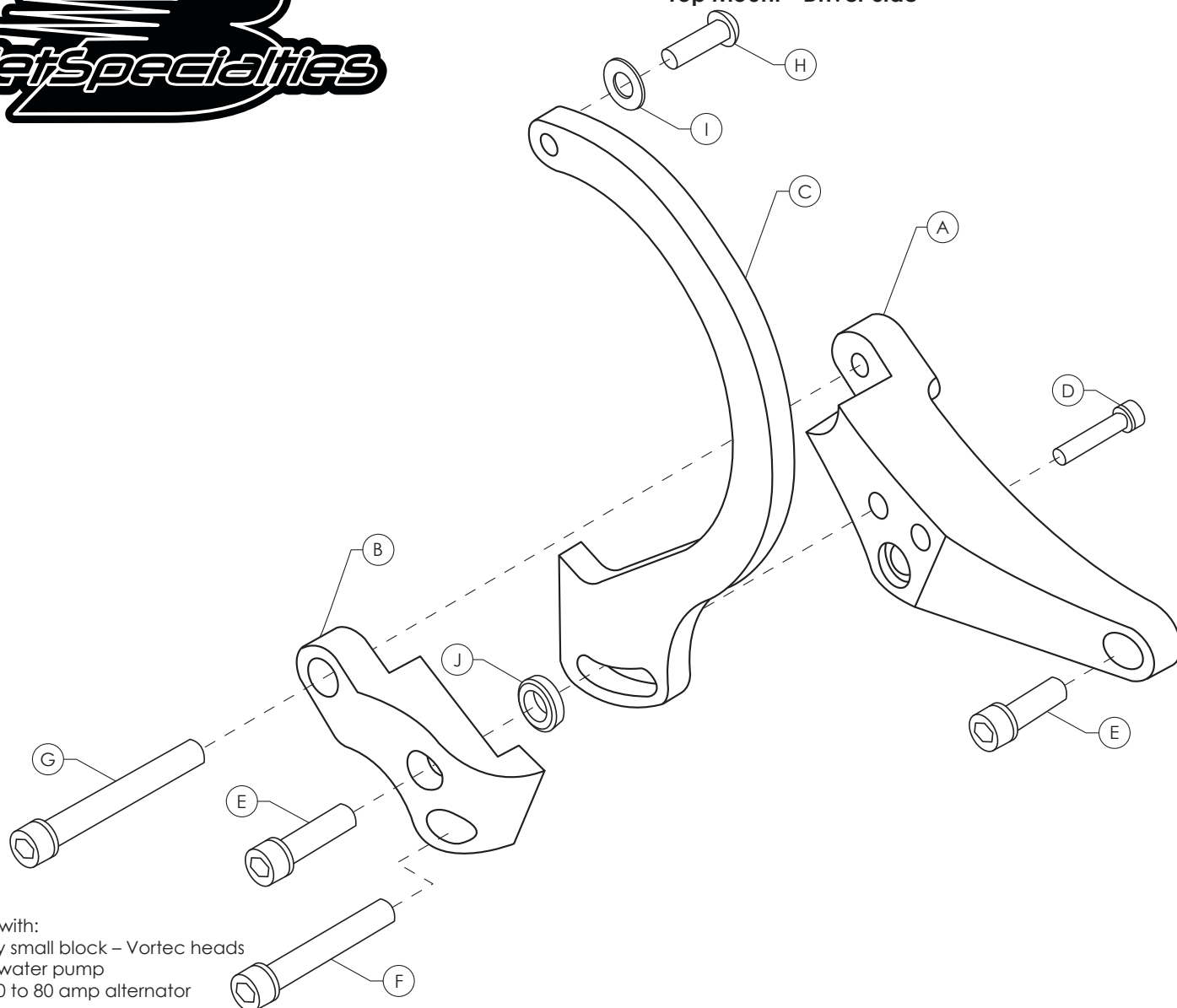

## #10720 Alternator Bracket Mount Instructions Top Mount - Driver Side



For use with:

- Chevy small block – Vortec heads
- Short water pump
- GM 60 to 80 amp alternator

1. Use Loctite® removable threadlocker 242 (blue) on all fasteners.
2. Bolt alternator back bracket [A] to alternator front bracket [B] using bolt [D] 1/4"-20 x 1-1/4" SHCS. Tighten. (May be preassembled).
3. Bolt alternator bracket [A-B] to drivers side head using bolt [E] 3/8"-16 x 1" SHCS and bolt [G] 3/8"-16 x 2-1/4" SHCS. Tighten.
4. Install stainless load washer [K] into counterbore on inside of bracket [B].
5. Bolt alternator adjustment arm [C] to backside of alternator top boss using bolt [I] 5/16"-18 x 1" BHCS and stainless flat washer [J]. Be sure and hook adjustment arm under alternator lower pivot boss. Tighten.
6. Bolt alternator with adjustment arm to bracket [A-B] using bolt [H] 3/8"-16 x 2-3/4" SHCS. Do not fully tighten.
7. Install bolt [F] 3/8"-16 x 1-1/4" SHCS into bracket [A-B]. Do not fully tighten.
8. Install alternator belt on rear groove when using 2-groove pulleys.  
Goodyear: #15495      Gates: #7490XL      Belt: 7/16" x 49"
9. Apply tension on alternator belt and tighten bolts [F] 3/8"-16 x 1-1/4" SHCS and [H] 3/8"-16 x 2-3/4" SHCS.

### BILL OF MATERIALS

ITEM	QTY.	DESCRIPTION	SIZE
A	1	Alternator Back Bracket	
B	1	Alternator Front Bracket	
C	1	Alternator Adjustment Arm	
D	1	1/4"-20 Socket Head Cap Screw	1-1/4"
E	2	3/8"-16 Socket Head Cap Screw	1"
F	1	3/8"-16 Socket Head Cap Screw	2-1/4"
G	1	3/8"-16 Socket Head Cap Screw	2-3/4"
H	1	5/16"-18 Button Head Cap Screw	1"
I	1	Stainless Flat Washer	9/16" x .060"
J	1	Stainless Load Washer	3/4" x 3/16"